

# Every Power.



## B3.3TAA

### B3.3TAA Ratings

ENGINE MODEL	ADVERTISED HORSEPOWER	PEAK TORQUE	ASPIRATION
B3.3TAA	85HP @ 2600 RPM	224 LB-FT @1600 RPM	Turbocharged/Charge Air Cooled
B3.3TAA	80HP @ 2200 RPM	224 LB-FT @1600 RPM	Turbocharged/Charge Air Cooled

ADDITIONAL RATINGS ARE AVAILABLE. CHECK WITH YOUR CUMMINS DISTRIBUTOR.  
Emission Certification: U.S. EPA Tier 3, CARB Tier 3, EU Stage IIIA

**Cummins Industrial Warranty** Coverage for two years or 2000 hours of operation, whichever occurs first, from the date of delivery of the power unit to the first user, or from the date the unit is first leased, rented or loaned, or when the power unit has been operated for 50 hours, whichever comes first. If the 2000 hour limit is exceeded during the first year, coverage continues until the end of the first year.

**Tier 3 Certified Fully Mechanical Engine** Meets U.S. EPA Tier 3, CARB Tier 3 & EU Stage IIIA Emission Certifications.

**Additional Front Crankshaft Pulley Groove & Aux. SAE "A" Drive** Provides greater versatility for accessory drive options. SAE A drive is 9-tooth standard, 10 & 11 tooth available.

**Cold Weather Starting Aid** Intake manifold heater grid provides better cold weather starting and white smoke control.

**Fully Engineered Solution** Proper sizing and option selection ensures maximum performance.

### Available Features

---

Air Cleaner 25 g/cfm w / Safety Element & Restriction Indicator - Top or Rear mount

---

Twin Disc Clutch PTOs or Hayes Pump Housings  
Vermeer Throttle Control

---

Full Enclosure

---

Electrical Wiring 12 Volt

---

Heater Starting Aid (grid)

---

Instrument Panel Mount - Open or Loose

---

Instrument Panel - Key switch, permissive start button, heater grid lamp, isolated panel with enclosed lockable box. Includes oil pressure, water temp., voltmeter, and tachometer gauges.

---

Baseraill Engine Sub-Base  
Isolated & Non-isolated

---

Packaging for Domestic & International Shipping

---

Cooling System - Includes; radiator, fan, shroud, deaeration tank, guarding, tubes. Fully tested for Limiting Ambient Temps. Pusher and Puller fans available

---

Radiator Guard

---

Grill Type & Stone/Debris Type

---

Exhaust System

---

Industrial Muffler or Spark Arrester - Meets U.S. Forestry Service (5100-1b)

---

**Note:** All power units MUST include a Decal (DE), Baseraill (MM), Packaging (PP), Cooling (RA) & Restriction Indicator (RI) option.

## CUMMINS POWER PRODUCTS

# B3.3TAA

## B3.3TAA

## FR-92084

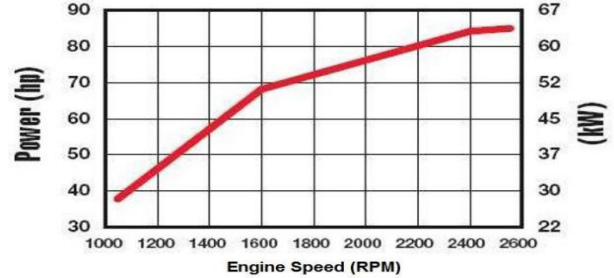
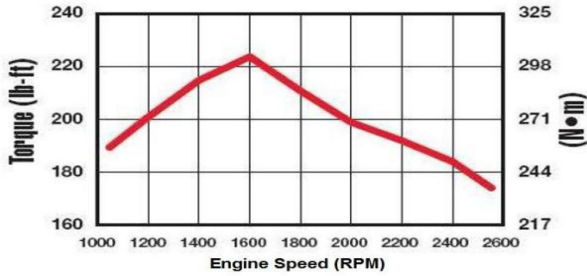

Curves shown above represent gross engine performance capabilities obtained and corrected in accordance with SAE J1995 conditions of 29.81 in Hg (100 kPa) barometric pressure [300ft (91m) altitude] 77 deg F (25 deg C) inlet air temperature, and 0.30 in Hg (1kPa) water vapor pressure with No. 2 diesel fuel.

All data is based on the engine operating with fuel system, water pump, and 15 in H<sub>2</sub>O (3.739 kPa) inlet air restriction with 3 in (76 mm) inner diameter, and with 3 in (76 mm) exhaust restriction with 3 in (76 mm) inner diameter; not included are alternator, fan, optional equipment and driven components.

The engine may be operated up to 7,546ft (2,300m) altitude before electronic derate is applied.

## Specifications

Advertised Horsepower	75-85 BHP	56-63 kW
Peak Torque	224 LB-FT	304 NM
Number of Cylinders	4	
Displacement	199 cu in.	3.3 Liters
Bore and Stroke	3.74 in x 4.53 in	95mm x 115mm
Aspiration	Turbocharged and Charge Air Cooled	
Oil System Capacity	7.4-11.6 U.S. Quarts	7.0-11.0 Liters
Power Unit Weight (Dry)	Open NA LBS	NA kg
	Enclosed NA LBS	NA kg
Total Cooling System Capacity	12.2 U.S. Quarts	11.5 Liters

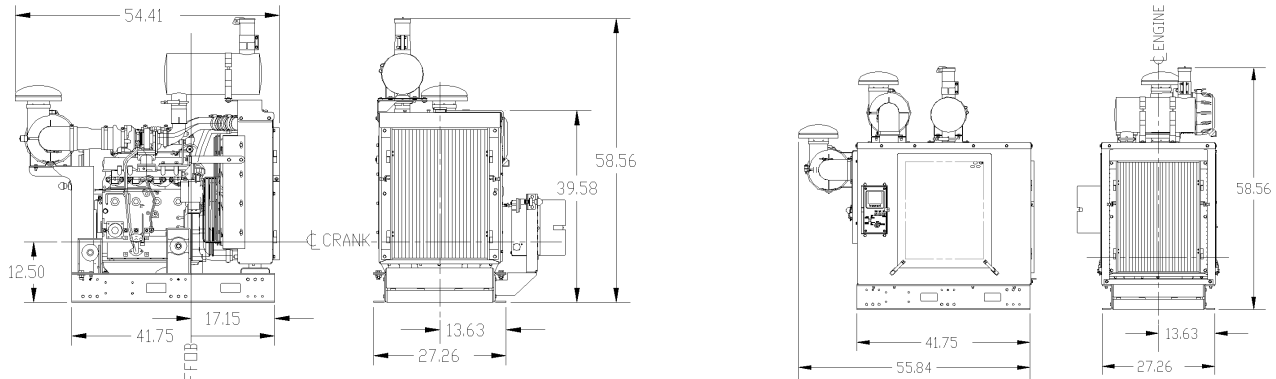

## Cummins Power Products

21810 Clessie Court  
 New Hudson, Michigan 48165  
 Phone: 248-573-1600  
 Fax: 248-573-4014  
 Internet: [cpp.cummins.com](http://cpp.cummins.com)